

### Typical product tabulates/典型性能

特点: 宽电压输入, 非隔离稳压单路输出

Characteristics: wide voltage, the non-isolated single output voltage regulation

效率高达 Efficiency up to : 96%

工作环境温度 Temperature range: -40°C~85°C

MTBF ≥ 200万小时 (20 × 10<sup>5</sup> Hrs)

符合RoHS指令 Comply with the RoHS directive)

低纹波、噪声 Low ripple and noise

小型SIP封装 Small SIP package

无需外加元件 No external component required

短路保护, 过热保护 Short Circuit Protect, Overheating protection

塑料外壳, 满足UL94-V0要求 Plastic case, up to standard of UL94-V0

### Z78xx-1000系列



### Typical product tabulates/典型产品列表

| 产品型号<br>Type | 输入电压 (Vdc)<br>Input voltage range |                   | 输出电压 (Vdc)<br>output voltageage |  | 输出电流<br>(mA)<br>Output<br>current | 静态电流<br>(mA)<br>Static<br>current | 纹波噪声<br>(Typ)<br>(mvp-p)<br><br>Ripple<br>noise | 最大容性负载<br>(uF)<br><br>Max<br>capacitive<br>load | 效率<br>(%, typ) |            |
|--------------|-----------------------------------|-------------------|---------------------------------|--|-----------------------------------|-----------------------------------|---|---|----------------|------------|
|              | 标称值<br>Nominal value              | 范围值<br>Rang value | 标称值<br>Nominal<br>value         |  |                                   |                                   |   |   | Vin<br>Min     | Vin<br>Max |
| Z7803-1000   | 24                                | 6~36              | 3.3                             |  | 1000                              | 7                                 | 15~35   | 680   | 90             | 80         |
| Z7805-1000   | 24                                | 8~36              | 5                               |  | 1000                              | 7                                 | 15~35   | 680   | 93             | 86         |
|              |                                   | 8~27              | -5                              |  | -500                              | 7                                 |   | 330   | 86             | 82         |
| Z7812-1000   | 24                                | 13~36             | 12                              |  | 1000                              | 7                                 | 15~35   | 680   | 96             | 93         |
|              |                                   | 8~20              | -12                             |  | -300                              | 7                                 |   | 330   | 89             | 88         |
| Z7815-1000   | 24                                | 20~36             | 15                              |  | 1000                              | 7                                 | 15~35   | 680   | 96             | 94         |
|              |                                   | 8~18              | -15                             |  | -300                              | 7                                 |   | 330   | 89             | 84         |

因篇幅有限, 以上只是部分产品列表, 若需列表以外产品, 请与本公司销售部联系

Due to space limitations, the above list is only for some products, if demand for others not included in the tabulates, please contact the Company's sales department

### Mechanical Data/封装尺寸

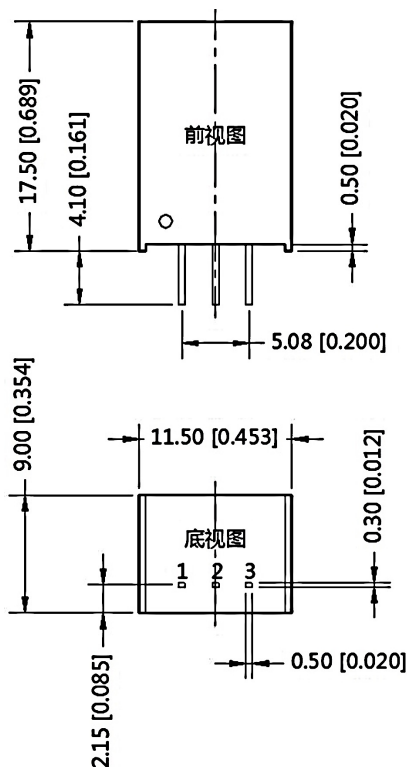

### 引脚方式

| 引脚 | 正输出 | 负输出 |
|----|-----|-----|
| 1  | Vin | Vin |
| 2  | GND | -Vo |
| 3  | +Vo | GND |

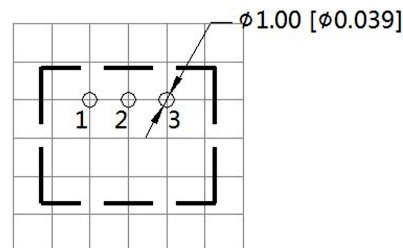

注: 栅格距离 2.54\*2.54mm

尺寸单位: mm 【inch】

端子直径公差:  $\pm 0.10$  【 $\pm 0.004$ 】

未标注之公差:  $\pm 0.25$  【 $\pm 0.010$ 】